

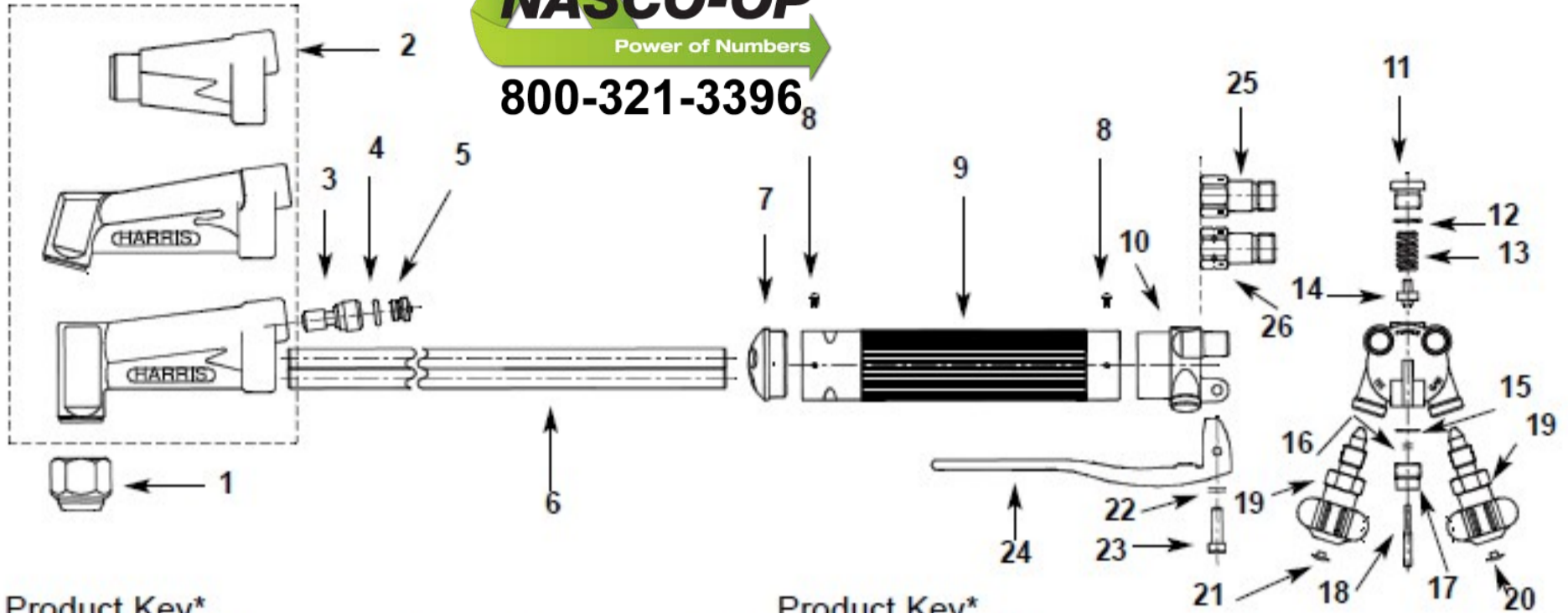

LINCOLN  
ELECTRIC

# STRAIGHT CUTTING TORCH

# 62-5



### Product Key\*

PART NO.	MODEL NO.	DESCRIPTION	CODE
1003340	62-5AL 21"	CUT-TCH,62-5AL 21"	A
1003350	62-5AE 18"	CUT-TCH,62-5AE 18"	B
1003360	62-5AF	CUT-TCH,62-5AF	C
1003370	62-5AFL 21"	CUT-TCH,62-5AFL 21"	D
1003430	62-5E ACET	CUT-TCH,62-5E ACET	E
1003440	62-5EL 21"	CUT-TCH,62-5EL 21"	F

### Product Key\*

PART NO.	MODEL NO.	DESCRIPTION	CODE
1003450	62-5F PROP.	CUT-TCH,62-5F PROP.	G
1003460	62-5BF PROPANE	CUT-TCH,62-5BF PROPANE	H
1003464	62-5AEL 21"	CUT-TCH,62-5AEL 21"	I
1003470	62-5FL 21"	CUT-TCH,62-5FL 21"	J
1003475	62-5F 18"	CUT-TCH,62-5F W/NYLATRON VLVS	K

\*NOTE: Torches available in other lengths.

### Parts List

REF. NO.	PART NO.	MODEL NO.	DESCRIPTION	CODE	REF. NO.	PART NO.	MODEL NO.	DESCRIPTION	CODE
1	9002560	6259-2	Nut, Tip	A thru K	11	9002580	6288-2	Tail,6288-2	BE,F,I
2	9003081	6244-8F	Head, 70°	A,F,C,D	12	9004612	6219-2A	Cap	A thru K
	9003085	6244-8E	Head, 70°	B,I	13	9002564	5057A	O-ring	A thru K
	9002512	6244-3A	Head, 180°	H,	14	9100507	6285-1	Spring	A thru K
	9003083	6244-8F	Head, 90°	G,J,K	15	9002486	B-62-A	Seat, Valve	A thru K
	9003088	6244-8E	Head, 90°	E,F	16	9004574	6239	Gasket,6239	A thru K
3	9100508	C-62	Injector	A	17	9002562	115X.070W	O-Ring,6D.115X.070W	A thru K
	9002528	6258-EP	Nozzle (requires 9004550)	B,E,F,I	18	9002548	6277-A	Screw,6277-A	A thru K
	9100510	C-62-F	Injector	C,D,G,H,J,K	19	9101150	6266	Plunger,6266	A thru K
4	9004550	10B	O-ring	B,E,F,I	20	9100503	A-62-C	Valve, Assy. (2)	A thru K
5	9002476	6219-3	Cap	A	21	8800376	AA-1789	Valve, Assy.(2) Nylatron	K
	9003530	7919-EP	Cap	B,E,F,I	22	8800377		Button,Red	A thru K
	9002478	6219-3F	Cap	C,D,G,H,J,K	23	9003360	76X96	Button,Green	A thru K
6	9002852	6292	Tube, 13" (3ea.)	B,C,E,G,K	24	9003342	7677-2	Washer,76X96	A thru K
	9003350	7692	Tube, 16" (3ea.)	A,D,F,H,I	25	9100500	7677-2	Screw,7677-2	A thru K
7	9005371	6219-5	Cap	A thru K	26	4300062	D-62-B	Lever Asy,D-62-B	A thru K
8	9000392	13X61	Screw,13X61 (6)	A thru K	27	4300061	88-6 CVTR	Check-Valve 88-6CVTR	A thru K
9	9002496	6243-3PS	Casing,6243-3PS 6"	A thru K	28	9002469	88-6 CVTL	Check-Valve 88-6CVTL	A thru K
10	9002578	6288-A	Tail,6288-A	A,C,D,G,H,J,K		6213-5	6213-5	Brace (not shown)	
						6271	6271	Ring, Silver solder(6)(not shown)	A thru K

### Service Notes

ITEM NO.	LUBE/ SEALANT	SERVICE TOOL OR NOTES	ITEM NO.	SERVICE TOOL OR NOTES
2		4600690 62-T-1C to reseal tip seat 4600700 7/8"-20 Die - 4600720 (62-T-11A) regrooving tool	6	Available in lengths: 31"-9002864 43"-8802725 72"-0016402 22"-8802721
10		4600930 76-T-2 To reseal needle valve seat A,C,D,G,H,K 4600935 62-T-15 6288-2 To reseal needle valve seat B,E,F,I 4600580 52-T-2L To reseal fuel gas hose seat 4600590 52-T-R To reseal oxygen hose seat 4600600 52-T-38 Die 9/16-18 L.H. 4600610 52-T-3 Die 9/16-18 R.H.	9	For longer lengths: 9002500 (36",48",27",72")
19,25,26		11/16 Open end wrench	27	27" & 36" (2ea.) 48" (3 ea.) 72" (4 ea.)
17,18	Molykote #55	Lubricate Prior to assembly	19,20 & 21	Assembly PN. 9101159