

CLS-420 Wireless Version

Cargo Lift Scale

Standard Features

Scale Carriage

- Compatible with Class II 16 in (H) or Class III 20 in (H) forklift cleat type carriages
- Out of level NTEP Certified tolerance at seven degrees pitch and roll, three degrees side to side
- 1 1/2 in thick front and back painted steel plates coupled by four flexures
- Top cleats are welded, pinned and bolted
- Welded centering pin
- Two 5,000 lb s-beam load cells
- Updated iQube[®] junction box with inclinometer
- Molded coiled cable, up to 15 ft uncoiled

420 Plus Indicator

- Stainless steel enclosure
- On/Off switch to conserve forklift battery life
- Front panel calibration
- Full numeric keypad for manual tare entry
- Accumulate weight function using the print key for multiple pallets
- Single RS-232 port transmits time, date and weight for interface to PC or printer
- 2 piece top cage indicator mounting assembly with vibration mounts
- 9-36 VDC power supply for use on propane forklifts or 10-60 VDC power supply for use on electric forklifts

802.15 Wireless Load Cell Kit with Rechargeable Smart Lithium Ion Batteries

- 802.15 wireless load cell kit from scale to indicator
- Eliminates coiled cable from junction box to indicator for use with two and three stage masts
- Reinforced battery box welded onto cover plate to withstand harsh forklift environment
- On/Off switch with LED and antenna mounted on the rear of the enclosure
- Battery life, minimum 24 hours constant use with only eight hours to fully charge
- Battery life indication is located on the battery
- Includes 2 batteries and charger
- Not intended for outdoor use

Printer Recommendations

- Rice Lake recommends using Datamax Microflash 2te

Presale Requirements

- Provide completed forklift questionnaire for quotation. A pre-installed load backrest on the forklift may interfere with flexures or wireless load cell interface option
- Compatible with most Class II and Class III forklift attachments, consult factory

Installation Recommendations

- When installing a forklift scale on an electric forklift, static discharge protection must be present on the forklift and install a chassis mount power conditioner to protect forklift electronics.
- When installing a forklift scale, OSHA requires the end user to de-rate the lift capacity of the forklift, see questionnaire for details



APPROVALS



Specifications

Scale Capacity:

- 28 in and 34 in: 5,000 lb x 5 lb NTEP Certified
- 38 in: 8,000 lb x 5 lb non-type approved

Scale Material/Finish:

Painted Steel

420 Plus Display:

0.8 in (20 mm), 6-digit super red light emitting diode (LED), 7-segment digits

420 Power - DC:

- Line voltages: 9-36 VDC DC input
- Power consumption: 0.75 A max fused at 5.0 A
- Line voltage 10-60 VDC input
- Power consumption: 0.75 A max fused at 5.0 A

420 Status Annunciators:

Designators for: center of zero, stand still, gross, net, lb, kg, tare

420 Operating Temperature:

- Legal: 14° F to 104° F (-10° C to 40° C)
- Industrial: 14° F to 122° F (-10° C to 50° C)

Warranty:

Two-year limited warranty

Approvals:

NTEP CC 06-074 (5,000 lb only) per H-44 at 1,000 divisions



www.nascoop.com | Phone: 800-321-3396

CLS-420 Wireless Version

Cargo Lift Scale

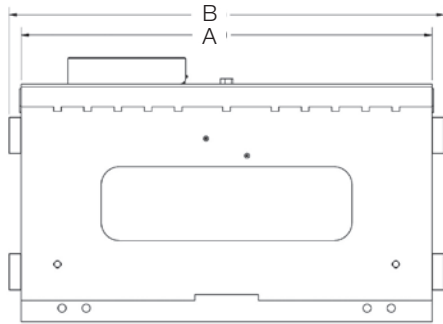

Front view

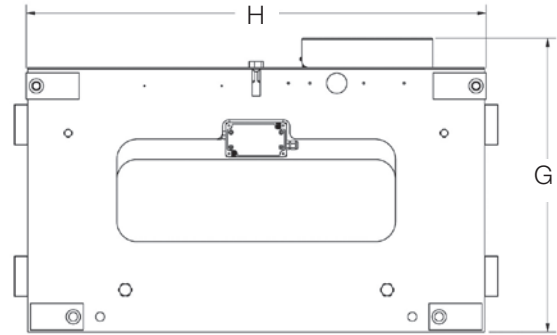

Rear view

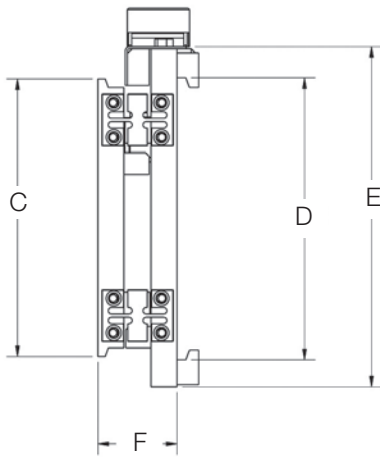

Side view

CLS DIMENSIONS

28 in, 5,000 lb

A	28	E	19.50
B	30	F	4.49
C	16	G	21.80
D	16.29	H	28.24

34 in, 5,000 lb

A	34	E	19.50
B	36	F	4.49
C	16	G	21.80
D	16.29	H	34.24

38 in, 8,000 lb

A	38	E	24.50
B	40	F	6.04
C	20	G	26.68
D	20.15	H	38

Contact factory for 28 in and 38 in front plate dimensions if adding an attachment

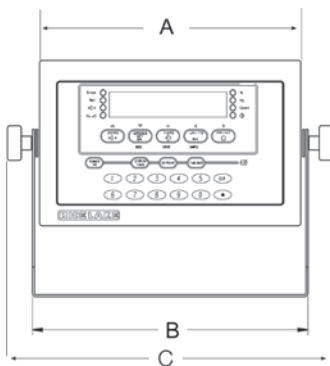

420 Plus side view

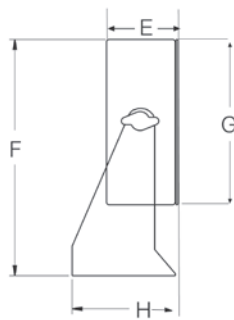

420 PLUS DIMENSIONS

A	9.50 in (24 mm)	F	8.57 in (217 mm)
B	10.02 in (254 mm)	G	6.00 in (152 mm)
C	11.80 in (299 mm)	H	3.25 in (82 mm)
E	3.12 in (79 mm)		



CLS-420 Wireless Version

Cargo Lift Scale

Part number/Price

PART #	SIZE, CAPACITY	FORKLIFT COMPATIBILITY	WEIGHT	PRICE
CLS Forklift Scale, 9-36 Volts for use propane forklifts and 12 volt battery				
171814	5,000 lb x 5 lb	28 in W, Class II 16 in forklift carriage (30 in W with flexures)	524 lb	Consult
167283	5,000 lb x 5 lb	34 in W, Class II 16 in forklift carriage (36 in W with flexures)	539 lb	Consult
171815*	8,000 lb x 5 lb non-Legal for Trade	38 in W, Class III 20 in forklift carriage (40 in W with flexures)	1144 lb	Consult
CLS Forklift Scale, 10-60 Volts for use electric forklifts and 36+ volt battery				
167418	5,000 lb x 5 lb	28 in W, Class II 16 in forklift carriage (30 in W with flexures)	524 lb	Consult
167284	5,000 lb x 5 lb	34 in W, Class II 16 in forklift carriage (36 in W with flexures)	539 lb	Consult
167410*	8,000 lb x 5 lb non-Legal for Trade	38 in W, Class III 20 in forklift carriage (40 in W with flexures)	1144 lb	Consult

*Non-NTEP Certified

Manufacturer recommends adding PN166161 to protect electronics against static

Options/Accessories

The following options and replacements parts below are available to use for the part numbers referenced above. To order replacement parts and options for products purchased prior to this catalog, contact the factory for assistance.

PART #	DESCRIPTION	PRICE
Consult	Wireless LAN card 802.11 B/G, requires factory installation	Consult
166161	DC Emi filter, chassis mount, 0-75 VDC input, 100 VDC surge protection	Consult
166162	DC-DC converter, chassis mount, 18-75 VDC input, 12 VDC output	Consult
Replacement Parts		
96915	Power cable assembly with power fuse cable	Consult
130129	Power fuse cable assembly	Consult
166623	RL20000 FLS load cell 5,000 lb 1.5 mV/V 350 ohm with turk connectors	Consult
166756	RL20000 FLS turk load cell connector	Consult
168000	CLS-420 iQube ² PCB assembly	Consult
96344	Battery charger	Consult
96343	Battery, forklift lithium ion	Consult
Manuals		
96483	CLS-420 installation manual	Consult
96484	CLS-420 operator card	Consult



www.nascoop.com | Phone: 800-321-3396

An ISO 9001 Registered Company © 2016 Rice Lake Weighing Systems 01/16 Prices and specifications subject to change without notice. Visit ricelake.com for current prices.