

TAYLOR MAGNET MASTER III

ASSEMBLY PART NUMBER	SIZE	CHAIN LEG				CAST BAIL					PIN		MAGNETS
		stock no.	No of Links	A	END LINK	stock no.	B	C	D	E	stock no.	WLL (lbs)	
0000-29113	3/4"	29013	3	19.50	0.875"x1.625"x4.500"	19002	9	5	3.5	11.25	19001	30,000	45"-48"
0000-29115	3/4"	29015	5	26.50	0.875"x1.625"x4.500"	19002	9	5	3.5	11.25	19001	30,000	45"-48"
0000-29123	7/8"	29023	3	22.25	1.000"x1.750"x5.500"	19002	9	5	3.5	11.25	19001	50,000	55"-58"
0000-29125	7/8"	29025	5	29.75	1.000"x1.750"x5.500"	19002	9	5	3.5	11.25	19001	50,000	55"-58"
9002-29133	1"	29033	3	25.00	1.125"x1.625"x6.500"	19002	9	5	3.5	11.25	19001	91,800	66"-78"
9002-29135	1"	29035	5	33.00	1.125"x1.625"x6.500"	19002	9	5	3.5	11.25	19001	91,800	66"-78"
0000-29135	1"	29035	5	33.00	1.125"x1.625"x6.500"	19004	13	8	5	16	19007	91,800	66"-78"
9004-29153	1-1/4"	29053	3	28.50	1.375"x2.750"x7.500"	19004	13	8	5	16	19007	141,000	83"-93"
9004-29155	1-1/4"	29055	5	37.50	1.375"x2.750"x7.500"	19004	13	8	5	16	19007	141,000	83"-93"
0000-29153	1-1/4"	29053	3	28.50	1.375"x2.750"x7.500"	19006	14.5	9.5	6	18	19009	141,000	83"-93"
0000-29155	1-1/4"	29055	5	37.50	1.375"x2.750"x7.500"	19006	14.5	9.5	6	18	19009	141,000	83"-93"

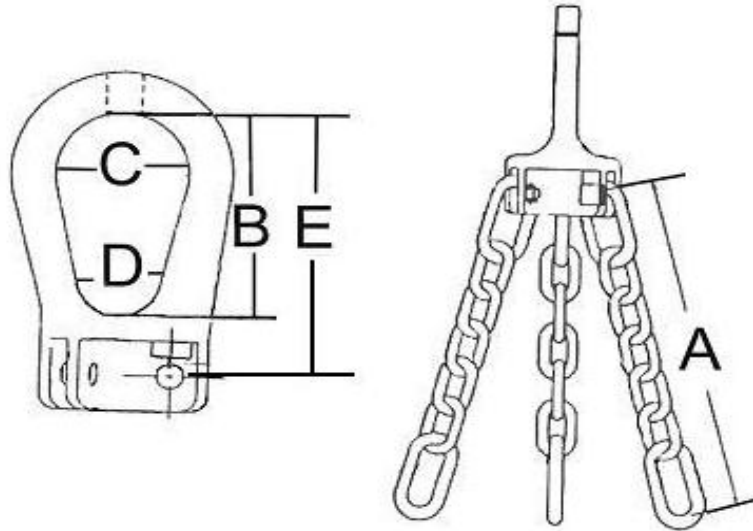

review date 17-Jun-10